

## Mine warfare - Mine laying

### The Cube™ Mine laying module

The multi-mission module as a turn-key system for containerized minelaying, which can be used on a naval vessel of opportunity with open access from the stern.

The system consists of a minelaying module and one or more storage modules capable of handling all known brands of sea mines.

Because of the 20-foot size corresponding with ISO

containers, the modules can be locked in place with Twist locks or equivalent. This makes it possible to use the system on various deck structures, such as helicopter landing decks or stern hangar decks with open access to the stern.

Several configurations using the standard minelaying module and storage module can lay the necessary minefield with various types of sea mines.

Continued next page >

Patent  
pending

It will even be possible to lay different types of sea mines simultaneously.

Vessels with sufficient space and outfitted with a sea state skidding system will obtain the capability to lay more than 400 sea mines continuously without having to pause the operation when changing the storage module.

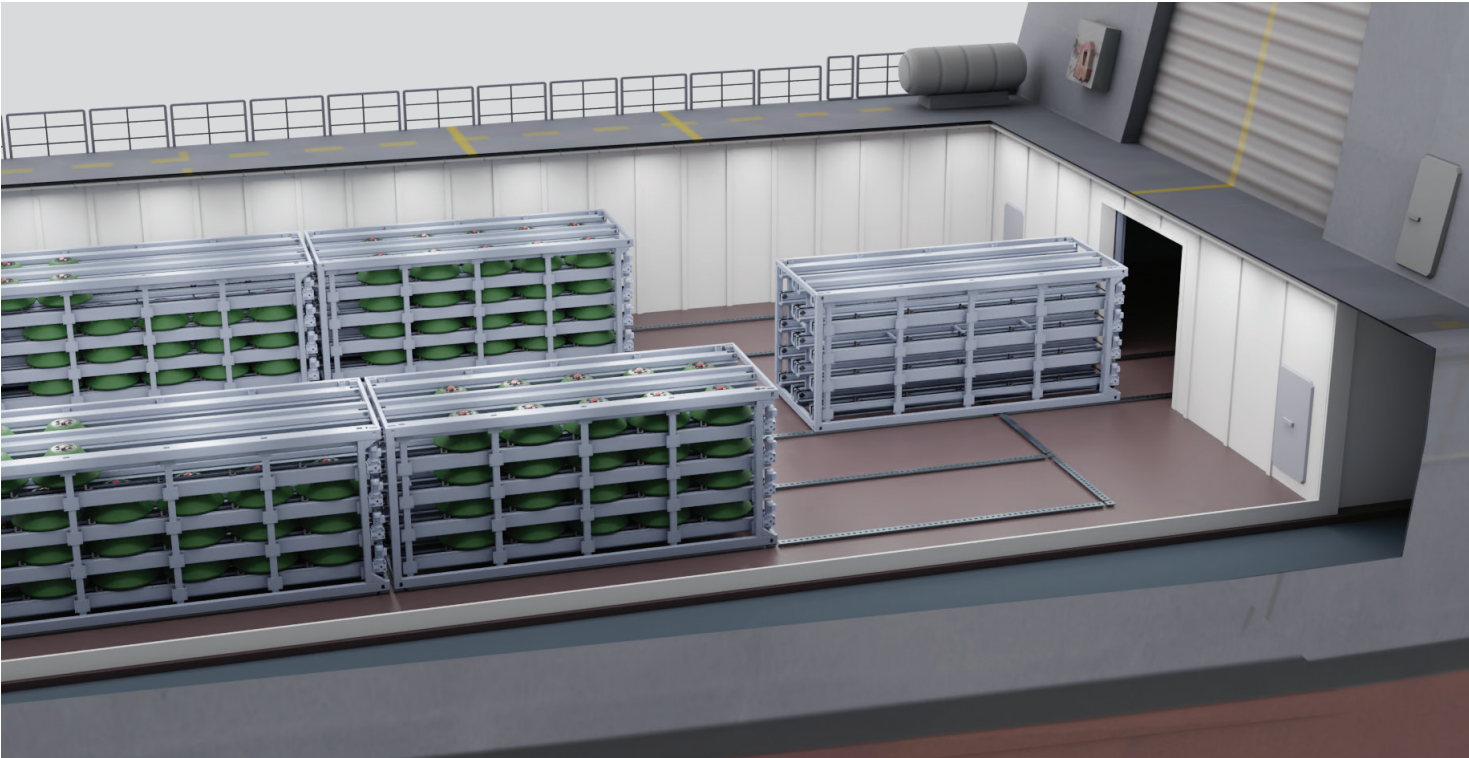
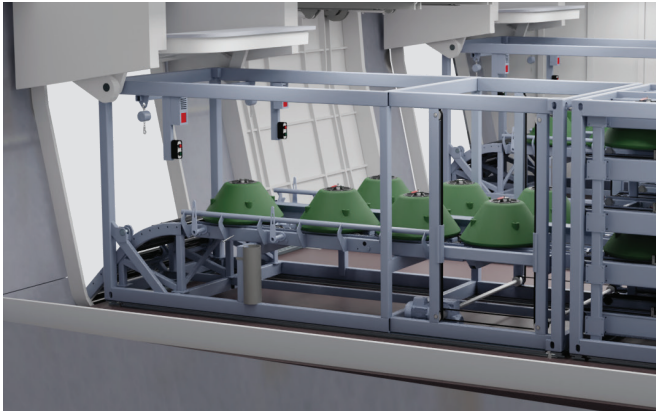

**Technical specifications – Minelaying Module**

Module size	1 x 20 foot (open frame type)
Weight	1Approx. 8 Ton
Shock approved	BV, DNV
Ammunition approved	Yes
Type of sea mines	All known brands
Sea mines per minute	2 - 4 (depending on type)



**The Cube™**  
Certified



**RWM ITALIA SPA**  
A RHEINMETALL COMPANY

**Technical specifications – Storage Module**

Module size	1 x 20 foot (open frame type)
Weight	12 – 18 Ton (depending on mine type)
Shock approved	BV, DNV
Number of sea mines	20 – 50 pcs. depending on type and shape
Types of sea mines	All known brands
Control	Fully Automatic